

TM 9-2320-360-24P

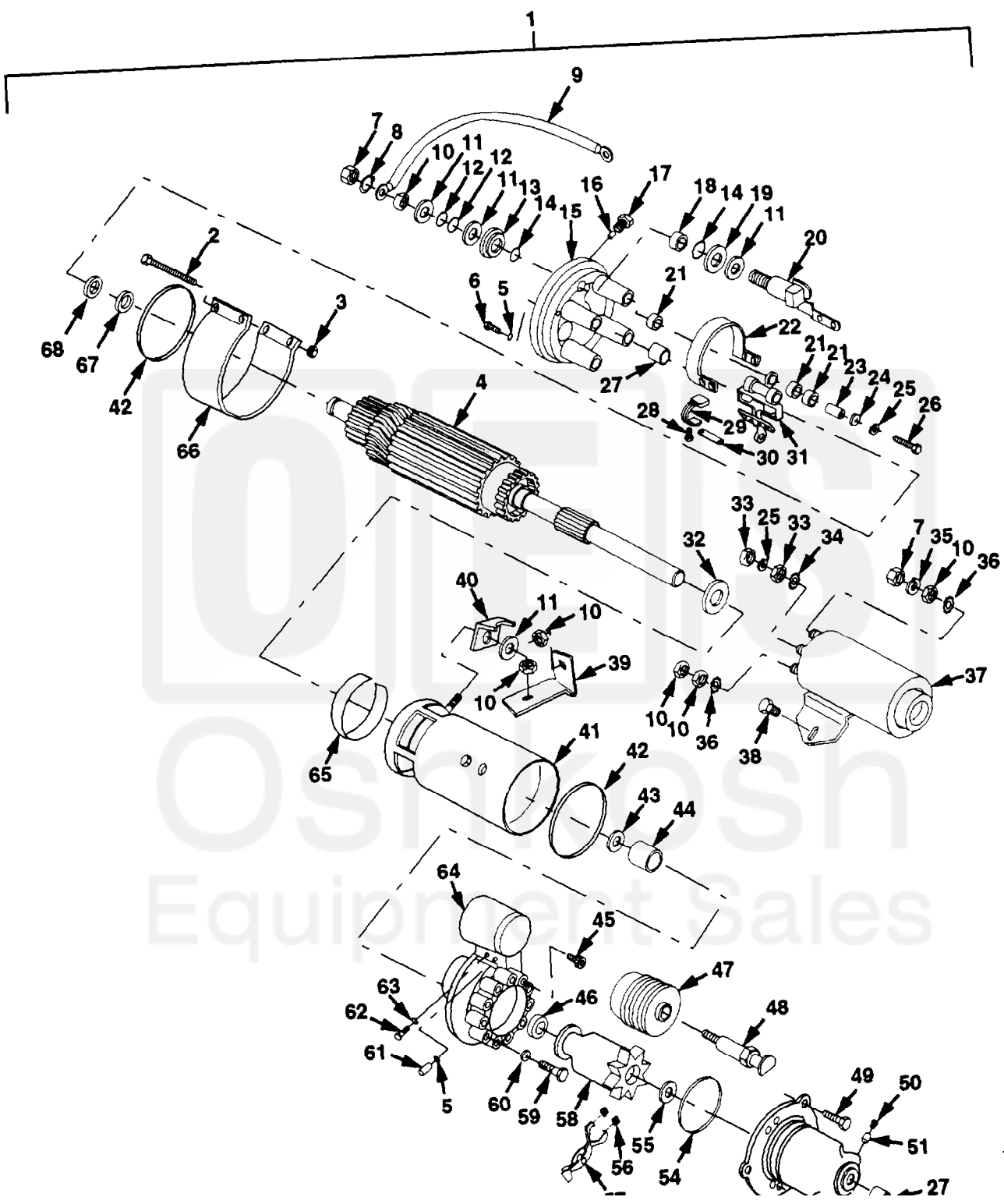

Figure 56. Starter Assembly

Section II. REPAIR PARTS LIST

(1) ILLUSTRATION		(2)	(3)	(4)	(5)	(6) DESCRIPTION	(7)	(8)
(a) FIG NO.	(b) ITEM NO.	SMR CODE	NATIONAL STOCK NUMBER	CAGE	PART NUMBER	USABLE ON CODE	UM	QTY INC IN UNIT
						GROUP 0603 STARTER ASSEMBLY		
56	1	PAOFF	2920-01-337-5152	35510	MO01094187	STARTER, ENGINE	EA	1
56	2	PAFZZ	5305-01-121-5475	35510	3966	.SCREW, MACHINE 10-24 X 7/8	EA	2
56	3	PAFZZ	5310-00-508-5439	35510	5955	.NUT, SQUARE 10-24	EA	2
56	4	PAFZZ	2920-01-162-0161	35510	97735	.ARMATURE	EA	1
56	5	PAFZZ	5330-00-633-6818	35510	71038	.PACKING, PREFORMED	EA	1
56	6	PAFZZ	5305-00-068-0502	96906	MS90725-6	.SCREW, CAP, HEX 1/4-20 X 3/4	EA	4
56	7	PAOZZ	5310-00-020-4787	68505	19X3439	.NUT, HEX 1/2-13	EA	2
56	8	PAOZZ	5310-00-584-5272	96906	MS35338-48	.WASHER, LOCK 7/16	EA	1
56	9	PAFZZ	2920-01-137-8043	35510	79568	.WIRE ASSEMBLY	EA	1
56	10	PAOZZ	5310-00-517-6564	35510	734505	.NUT, PLAIN, HEXAGON 1/2-13	EA	6
56	11	PAFZZ	5310-00-274-4546	35510	3249	.WASHER	EA	4
56	12	PAFZZ	5310-01-112-1740	35510	75777	.WASHER, SPRING	EA	2
56	13	PAFZZ	5970-01-308-0374	35510	95770	.INSULATOR	EA	1
56	14	PAFZZ	5330-01-304-3453	8E515	2053095777	.PACKING, PREFORMED	EA	2
56	15	PAFZZ	2920-00-764-7365	35510	73579	.HOUSING, COMM, END	EA	1
56	16	PAFZZ	9390-00-112-8047	35510	38406	.WICK, FELT	EA	1
56	17	PAFZZ	4730-00-044-4688	35510	21293	.PLUG, PIPE	EA	1
56	18	PAFZZ	5970-01-308-5176	35510	2082095771	.BUSHING, INSULATION	EA	1
56	19	PAFZZ	5970-01-307-6070	35510	95778	.INSULATOR, WASHER	EA	1
56	20	PAFZZ	2920-00-058-6608	35510	55272	.JUMPER ASSEMBLY	EA	1
56	21	PAFZZ	5970-01-118-6746	35510	78420	.WASHER, INSULATION	EA	12
56	22	PAFZZ	2920-01-076-9812	35510	95971	.JUMPER	EA	1
56	23	PAFZZ	5970-01-118-6753	35510	78421	.INSULATOR, BUSHING	EA	4
56	24	PAFZZ	5310-00-442-0966	83298	19128	.WASHER	EA	4
56	25	PAOZZ	5310-00-775-5139	35510	2434	.LOCKWASHER NO. 10	EA	5
56	26	PAFZZ	5305-01-312-4837	35510	95280	.SCREW, MACHINE 10-32 X 1	EA	4
56	27	PAFZZ	3120-00-064-1723	35510	38401	.BUSHING	EA	2
56	28	PAFZZ	5305-00-984-6191	96906	MS35206-243	.SCREW, MACHINE #8-32 X 3/8	EA	8
56	29	PAFZZ	5977-00-758-9555	75263	4393-55	.BRUSH KIT	EA	1
56	30	PAFZZ	5340-01-127-5636	35510	57022	.PLATE, LOCK	EA	4
56	31	PAFZZ	5977-01-155-7352	35510	52720	.BRUSH HOLDER	EA	4
56	32	PAFZZ	3120-01-304-8571	35510	2095095929	.WASHER, THRUST	EA	1
56	33	PAOZZ	5310-01-106-9929	35510	2313	.NUT, HEX #10-32	EA	2